

EC254 PR%24

Pitch:	25.4 mm
Belt Surface:	Open, Smooth Surface
Minimum Width:	152 mm
Open Area (%):	%24. (Biggest opening 2.4x6.5 mm)
Flight:	Yes (T25, T50, TF75, TF100)
Side Wall:	Yes (h=25 mm, h=50 mm)
Rod:	Ø4.9 mm
Approved:	FDA and EU
Curve:	No
Color:	Additional colors available
Cleanability:	Excellent
Belt Width:	9,5 mm

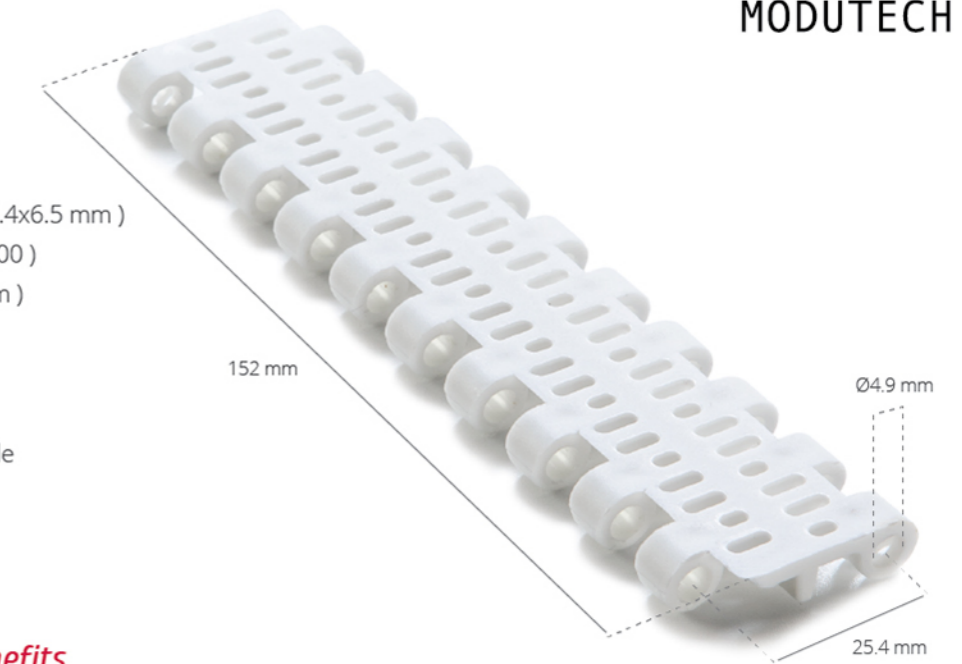

Product Features and Functional Benefits

- Unique sprocket engagement - precise indexing, easy cleaning.
- Different openings to optimize performance in cooling and draining applications.
- Easy to clean reduces downtime for cleaning time %70.
- Reduces bacteria growth.

EC254 PR%24 / Technical Information

BELT MATERIAL	BELT STRENGTH				TEMPERATURE		BELT WEIGHT
	Straight		Curve		C(min.)	C(max.)	Kg/m ²
	Kg/m	N/m	Kg/m	N/m			
Polypropylene	780	7800	-	-	+5	+90	3.80
Polyethylene	714	7140	-	-	-73	+66	4.20
Acetal	1092	10920	-	-	-43	+110	5.70

- Belt strength and temperature values are maximum on the table.

EC254 PR%24 / Standard Belt Widths

BELT SERIES	WIDTH (W)				Belt Width Tolerance (max.)
	PP-PE		POM		
	(mm)	(inch)	(mm)	(inch)	
EC254	152,4	6"	152,4	6"	± 0,5 mm
EC254	228,6	9"	228,6	9"	± 2 mm
EC254	304,8	12"	304,8	12"	± 2 mm
EC254	381	15"	381	15"	± 3 mm
EC254	457,2	18"	457,2	18"	± 3 mm
EC254	533,4	21"	533,4	21"	± 3 mm
EC254	609,6	24"	609,6	24"	± 3 mm
EC254	685,8	27"	685,8	27"	± 4 mm
EC254	762	30"	762	30"	± 4 mm
EC254	838,2	33"	838,2	33"	± 4 mm
EC254	914,4	36"	914,4	36"	± 4 mm
EC254	990,6	39"	990,6	39"	± 4 mm
EC254	1066,8	42"	1066,8	42"	± 4 mm
EC254	1143	45"	1143	45"	± 4 mm

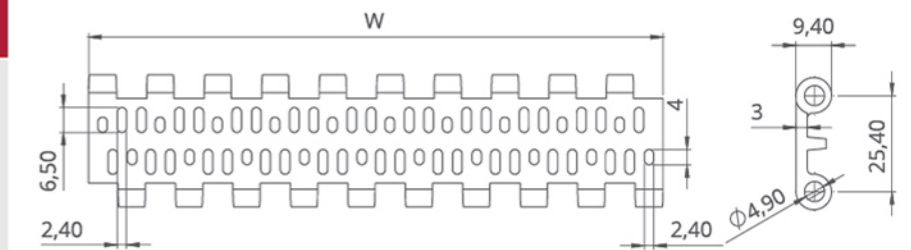

- Standard belt increments 76.2 mm.
- Non standard belt increments 15 mm.
- Please contact with customer service for precise belt measurements.

EC254 PR%24

Modular Belt Series

• Meat and Poultry Applications

General Conveyance and Breeding Lines

• Fruit and Vegetable Applications

Including Elevators, Steam Peeler, Inspection Tables

• Seafood Applications

Including Elevators, Inspection Tables, Grading Lines, Trim Lines, Glazing Lines, Cooking Lines

• Bakery Applications

Including Raw Dough Handling, Cooling Lines, Icing Lines, Packing Lines, Metal Detectors

EC254 Series Sprockets and Technical Specifications

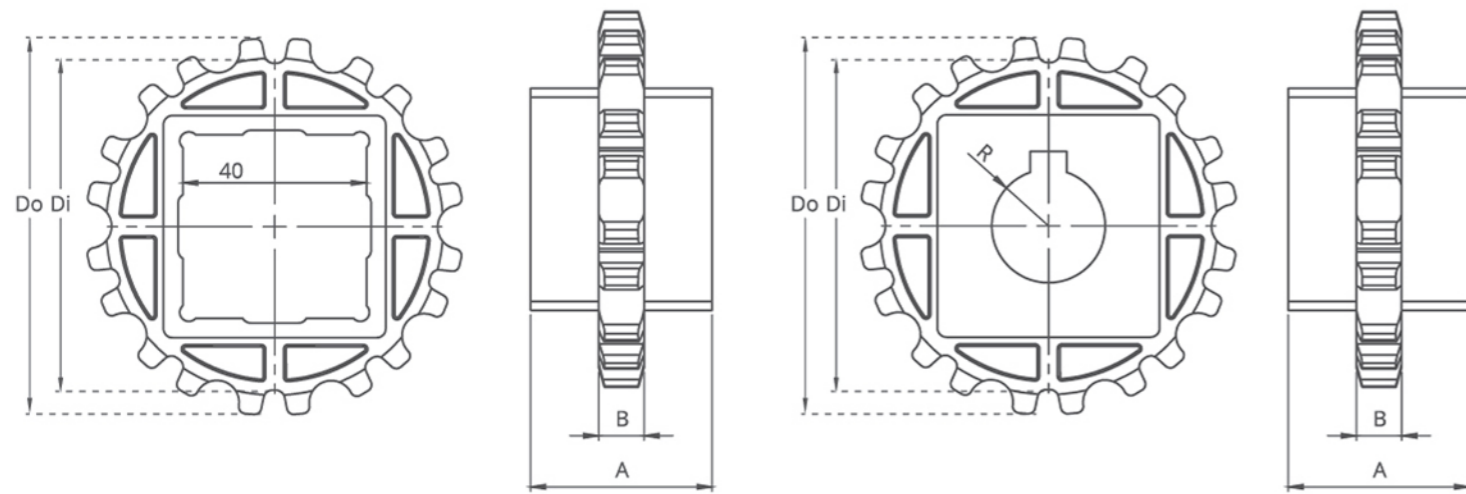

EC254 Series / Standard Sprockets Dimensions

NO.TEETH	Di	Do	B	A	Square Bore (Q)	Round Bore (R)	PRODUCT CODE	
							Square Type (Q)	Round Type (R)
Z10	72.0 mm	83.0 mm	10.0 mm	40.0 mm	40.0 mm	25.0 / 30.0	EC254SQZ10*PA	EC254SRZ10*PA
Z15	112.0 mm	123.0 mm	10.0 mm	40.0 mm	40.0 mm	25.0 / 30.0	EC254SQZ15*PA	EC254SRZ15*PA
Z18	137.0 mm	147.5 mm	10.0 mm	40.0 mm	40.0 mm	25.0 / 30.0	EC254SQZ18*PA	EC254SRZ18*PA

*Other sprockets and hub sizes are manufactured up to request.
 *POM (Acetal) and PP (Polypropylene) sprockets raw material is available on request.

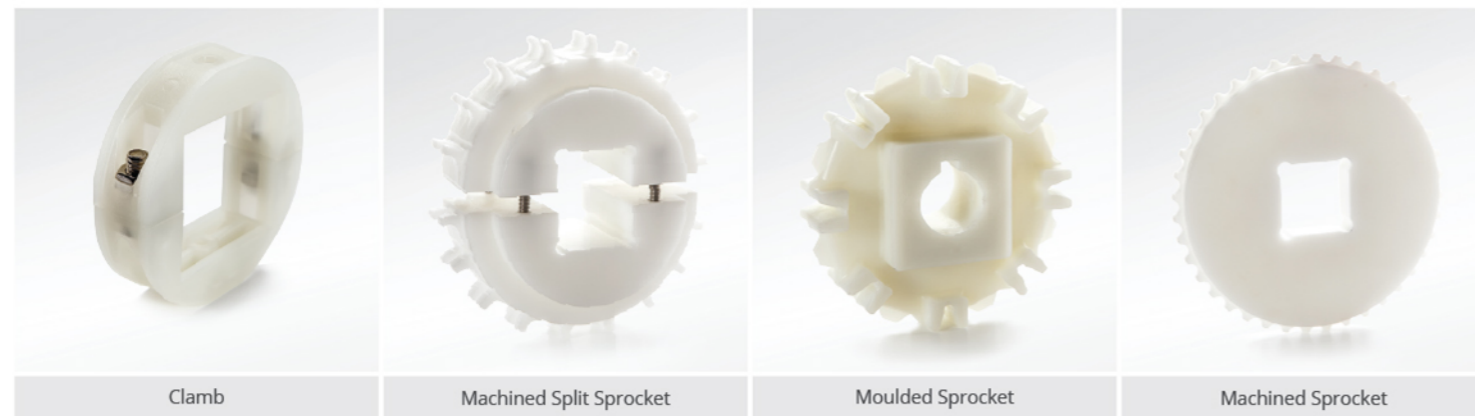

EC254 Series Accessories and Technical Specifications

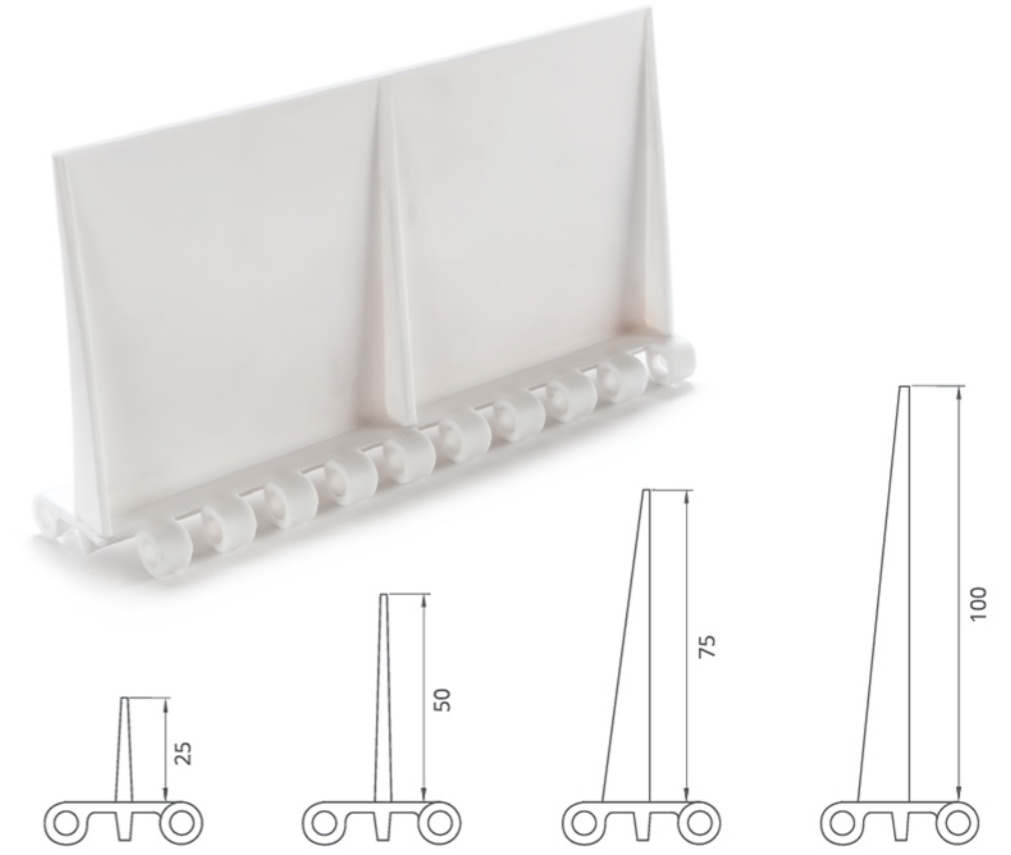

EC254 Series / Flight Technical Specifications

Possible Flight Indets for 25,4 mm Series	Z	
	(mm)	(inch)
Standart, no module cutting	15	0,59
Standart, no module cutting	30	1,18
Standart, no module cutting	45	1,77
Standart, no module cutting	60	2,36
Standart, no module cutting	75	2,95

*Non-standard flight indent is on request.

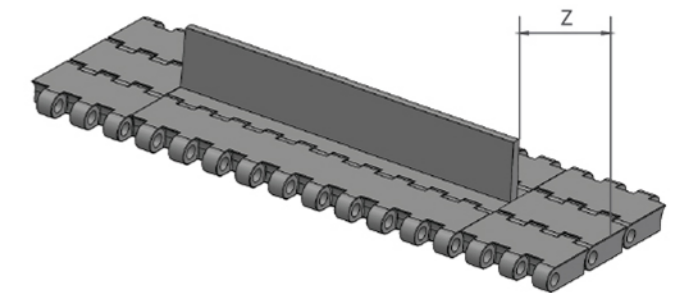

EC254 Series / Sidewall Technical Specifications

Possible Sidewall and Flight Indets	X		Y	
	(mm)	(inch)	(mm)	(inch)
Standart, no module cutting	24	0,94	15	0,59
Module cutting necessary	32	1,26	22	0,87
Standart, no module cutting	40	1,57	30	1,18
Module cutting necessary	48	1,89	37	1,46
Standart, no module cutting	56	2,20	45	1,77
Module cutting necessary	64	2,52	53	2,09

Note: Gap between flight and sidewall minimum 2-3 mm
 Gap between flight and sidewall maximum 10 mm

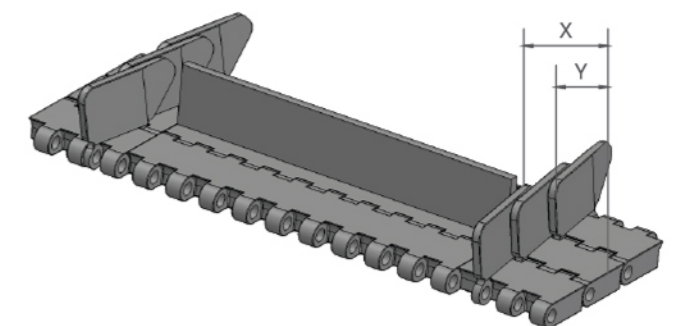

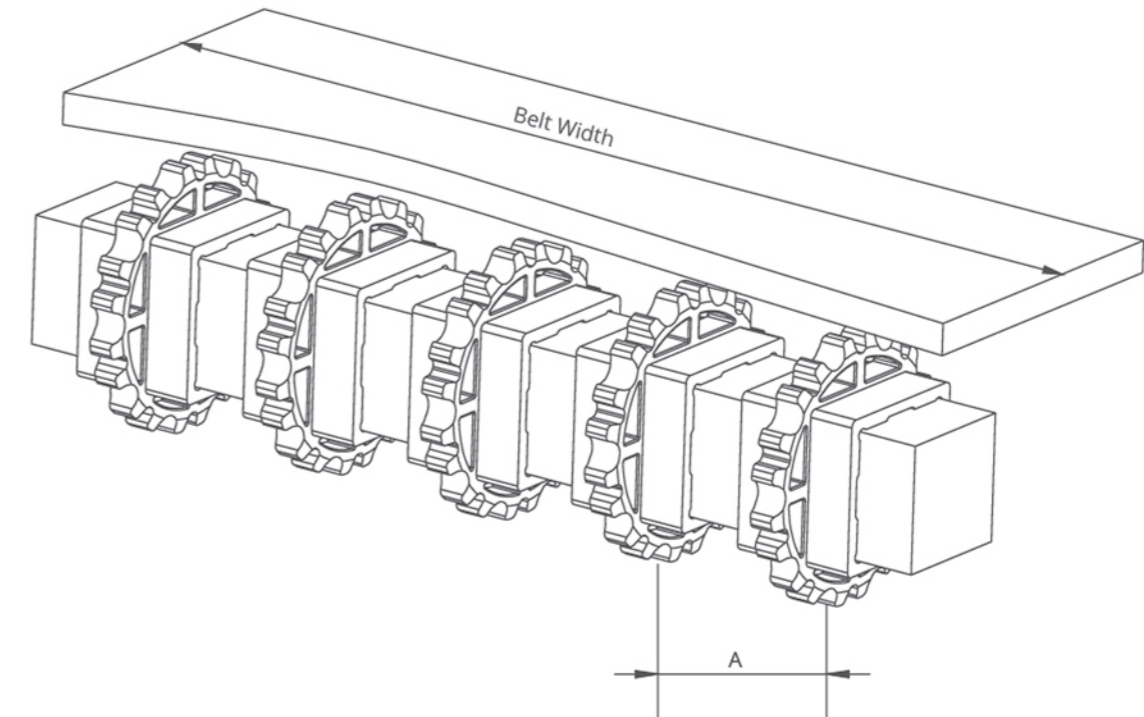
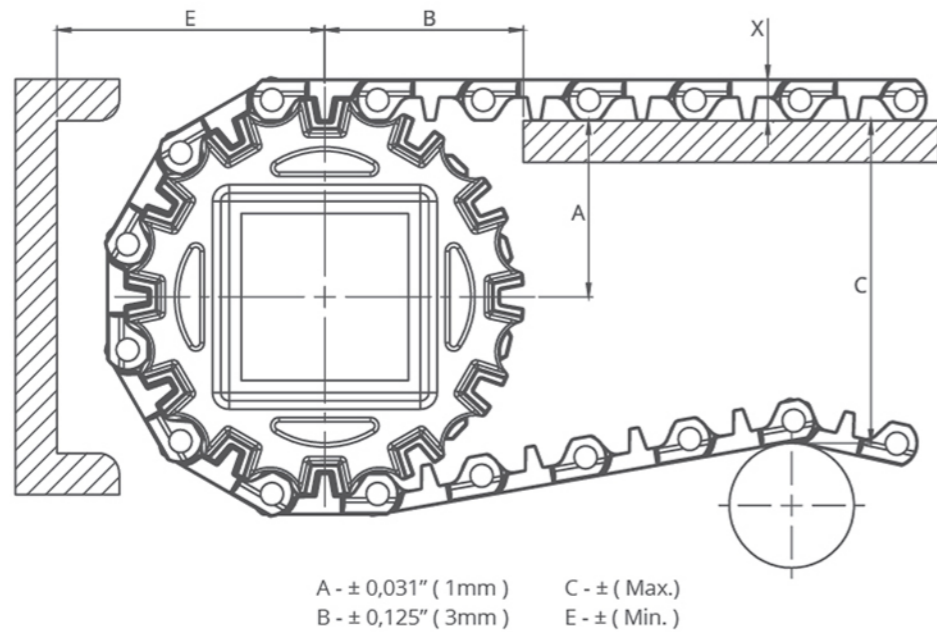

EC254 Series / Conveyor Frame Dimensions

Sprockets Description			A		B		C		E		X	
Pitch Diameter		No.Teeth	Range (Bottom to Top)		In.	mm	In.	mm	In.	mm	In.	mm
In.	mm		In.	mm								
EC254 C, EC254 PR%24												
2,95	75	10	1,34	34	1,77	45	2,44	62	2,22	56,5	0,39	10
3,54	90	12	1,67	42,5	1,89	48	3,05	77,5	2,54	64,5	0,39	10
4,57	116	15	2,16	54,75	2,17	55	3,62	92	3,07	78	0,39	10
5,53	140,5	18	2,64	67	2,38	60,5	4,65	118	3,48	88,5	0,39	10

EC254 Series / Sprockets Arrangement

Standard Belt Width		Number of sprockets per shaft		A (mm/inch)	
mm	inch	Drive Shaft	Return Shaft	Min.	Max.
152,4	6	2	2	60/2,36	170/6,6
228,6	9	2	2	60/2,36	170/6,6
304,8	12	3	2	60/2,36	170/6,6
381	15	4	3	60/2,36	170/6,6
457,2	18	5	3	60/2,36	170/6,6
533,4	21	5	3	60/2,36	170/6,6
609,6	24	6	3	60/2,36	170/6,6
685,8	27	6	4	60/2,36	170/6,6
762	30	7	4	60/2,36	170/6,6
838,2	33	7	4	60/2,36	170/6,6
914,4	36	8	4	60/2,36	170/6,6
990,6	39	8	5	60/2,36	170/6,6
1066,8	42	9	5	60/2,36	170/6,6
1143	45	9	5	60/2,36	170/6,6
1219,2	48	10	5	60/2,36	170/6,6
1295,4	51	10	6	60/2,36	170/6,6
1371,6	54	11	7	60/2,36	170/6,6
1447,8	57	11	7	60/2,36	170/6,6
1524	60	12	7	60/2,36	170/6,6
1600,2	63	12	8	60/2,36	170/6,6
1676,4	66	12	8	60/2,36	170/6,6
1752,6	69	13	8	60/2,36	170/6,6
1828,8	72	14	9	60/2,36	170/6,6
1905	75	14	9	60/2,36	170/6,6
1981,2	78	15	10	60/2,36	170/6,6
2057,4	81	15	10	60/2,36	170/6,6

EC254 Series / Slider Support System For Straight Running Belts

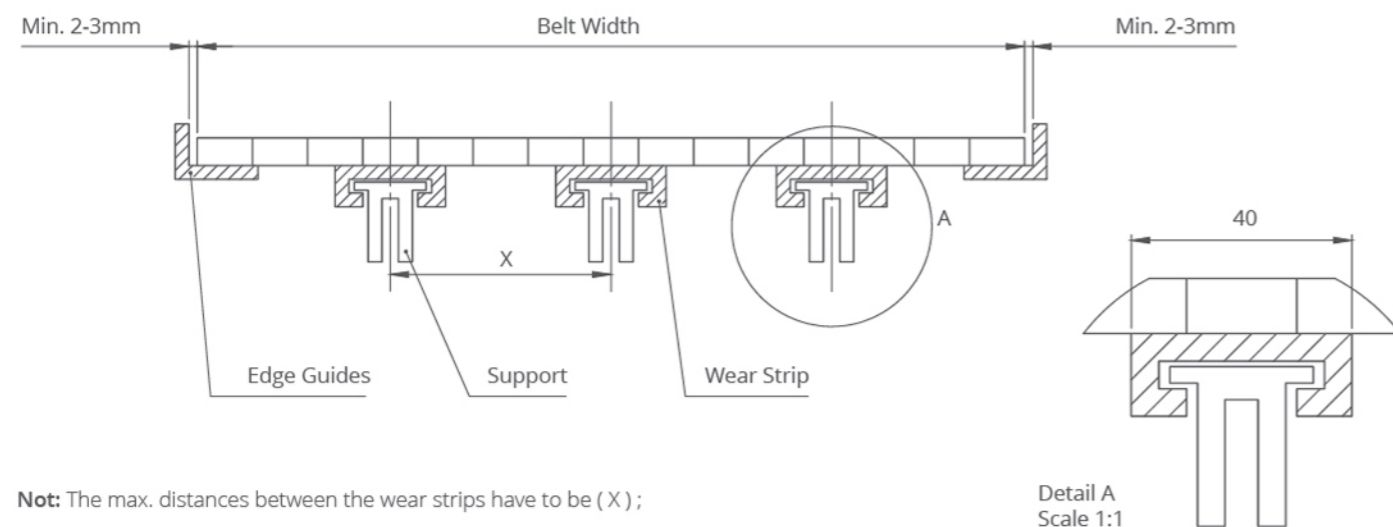

Not: The max. distances between the wear strips have to be (X);

125 mm for 2" belts
80 mm for 1" / 0.5" belts

Note: Number of sprockets depends on the belt load.